

NOTES :

Figured dimensions only are to be taken from this drawing. All dimensions are to be checked on site before any work is put in hand.

The Copyright of this drawing is owned by SALT Architects

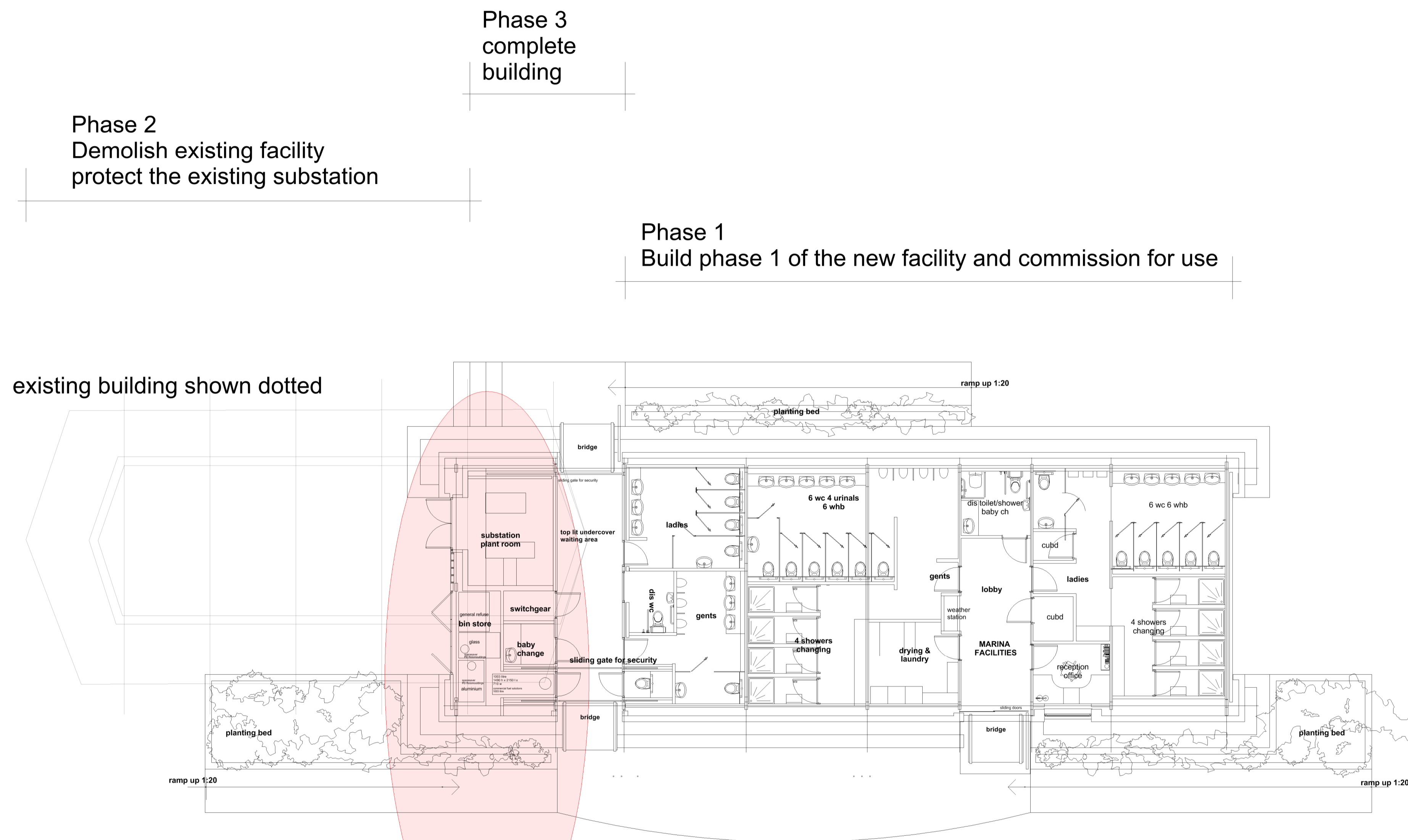

The existing facility contains an electrical substation which serves the Marina and associated facilities. The need to keep the existing facilities and public conveniences in use throughout the new build period has influenced our decision making for the project. The new building will be phased to allow the existing facilities to be kept open until the new facility is handed over. The existing facility will then be demolished and the final bay of the new building which will enclose the Electrical substation, bin store, and baby change unit will be completed. The works to the car park will then be completed.

Revision Details	Drawn	Date
Mark Revision	Drawn	Date Checked

SALT architects
 54 Lairgate, Beverley,
 East Yorkshire
 HU17 8EU
 telephone 01482 888102
 fax 01482 888621

Client's name
 Scarborough BC

Job title
 Whitby Marina Onshore Facilities

Drawing title
 Demolition Plan

Scale
 1:100

Drawn	Checked	Date
gh		10/10/08
Job No	Drawing No.	Rev
2348	02	-
Status	planning	